

SPECIFICATION FOR HIGH RESILIENT FOAM PRODUCTS

1. Types of high foam product required include mattresses, pillows and cushions. They shall comply with the American Standard ATSM D 3770-79, with standard methods of Testing Flexible Cellular Materials ASTM D 3574-81.

2. Appearance
 - (a) Colour is whitish yellow.
 - (b) Colour must be of the minimum and unobjectionable.
 - (c) All items should be fully moulded throughout and free from any visual defects.

3. Hardness
 - (a) All mattresses will be supplied in medium density.
 - (b) All pillows and cushions will also be supplied in soft density.

Modulus or comfort factor is high, load bearing characteristic is similar to that of latex foam in ratio of foam hardness to foam density.

Resilience of the foam mattress which is typically about 60% in latex foam (typically about 45).

The typical physical properties of the high resilient are table as follows:

(a) Density	-	46.3 kg/m ³
(b) Indentation force deflection (IFD) at 25%	-	72N
(c) Support factor 65% IFS/ 25% IFD	-	2.96
(d) Recovery ratio 25% R/ 25% IFD	-	89.6%
(e) Compression set at 75% deflection	-	2.5%
(f) Tenstile strength	-	63.2 kpa
(g) Elongation	-	102%
(h) Tear strength	-	102 N/m
(i) Resillience (ball rebound)	-	62%

4. Material

The material shall contain nothing known to be injurious to human tissues.

The material shall be uniform in texture and the skin shall be intact. Repairing is permissible provided that, after repair, the article meets the specification.

5. Covering

The quality of the material should be such that adequate protection is afforded to the 'high resilient' foam interior and the material should possess hard wearing properties. The 'cover' could be easily taken out and wash without damaging the foam.

Covering materials should be pre-shrunk calico.

6. Sample and test certification

All sample are to be test in accordance with the American Standard ASTM D 3770-79 by SIRIM. Routine quality control test are perform frequently.

TILAM SPRING

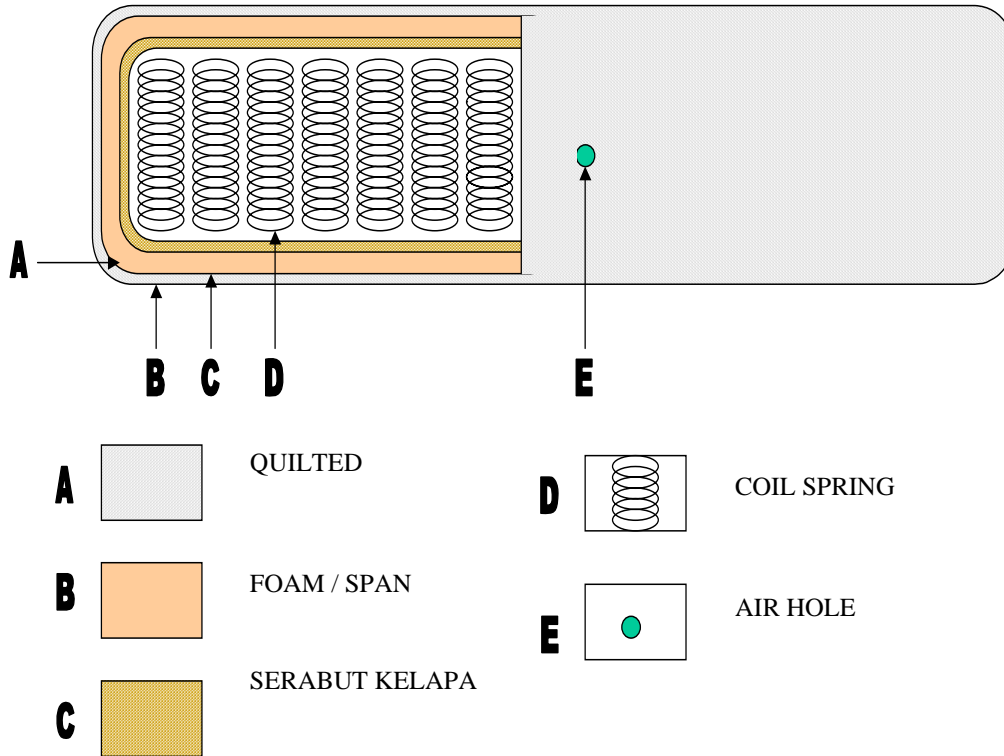

A. Tilam bujang 6'3" X 5'0" X 8"

- I. Menggunakan 2mm (dia) 'core wire' sebagai 'coil spring'.
- II. 336 'coil spring' untuk setiap tilam bujang.
- III. Menggunakan 4mm (dia) 'core wire' untuk garisan sempadan dan 'stabilizer'.
- IV. 4 unit 'stabilizer' sudut untuk ketahanan.
- V. 6 unit 'stabilizer' sisi supaya tidak mudah beralih-alih.
- VI.. ½" serabut kelapa.
- VII. 1" lapisan foam (kalis api).
- VIII. 'Quilted materials' yang bermutu tinggi.
- IX. 4 unit 'air hole' (2 unit untuk kedua-dua sisi tilam).

TILAM LIPAT TIGA

6'3" X 3' X 4"

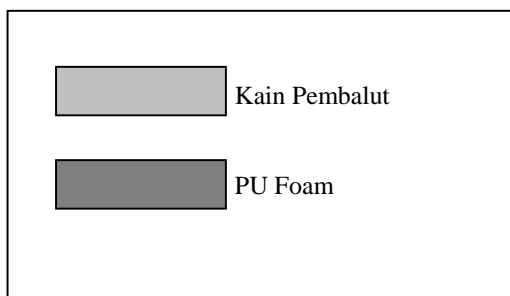
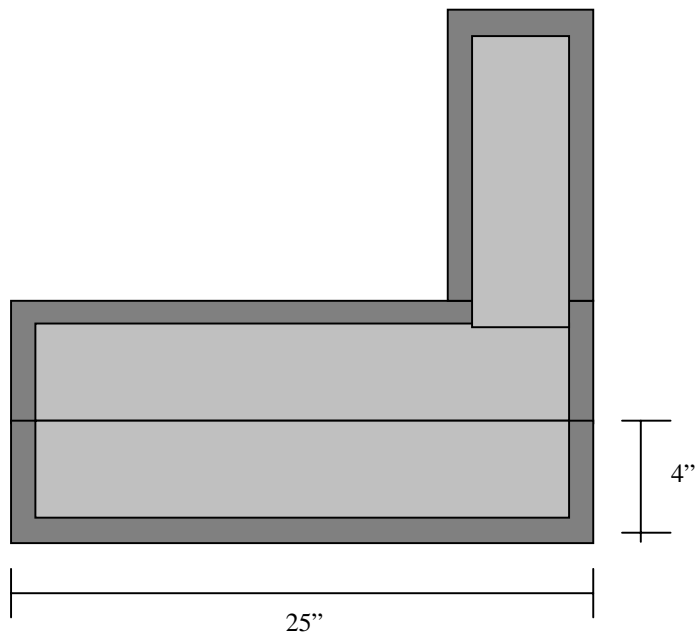
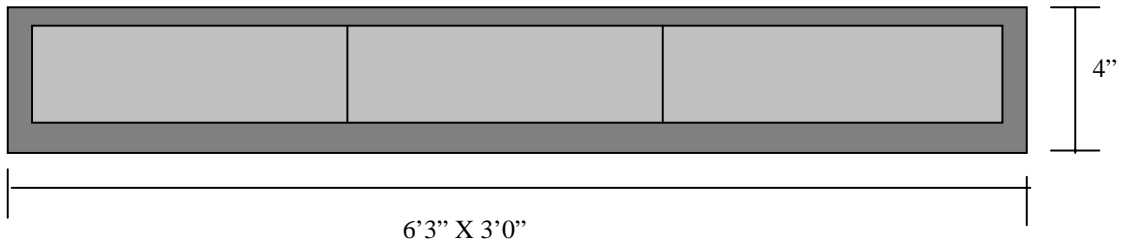

TILAM LIPAT TIGA
6'3" X 3' X 2"

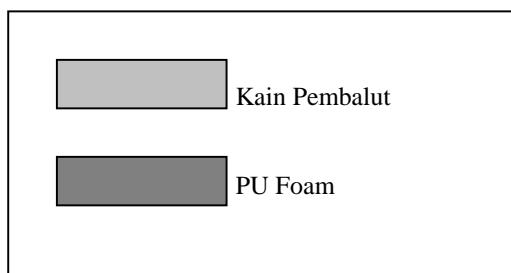
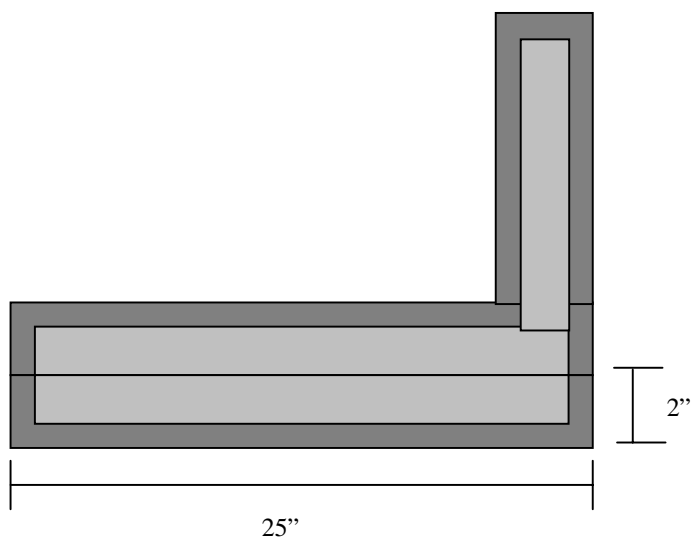
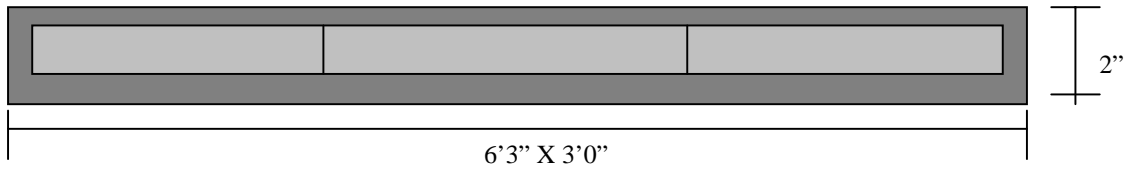

TILAM SERBAGUNA BOLEH GULUNG

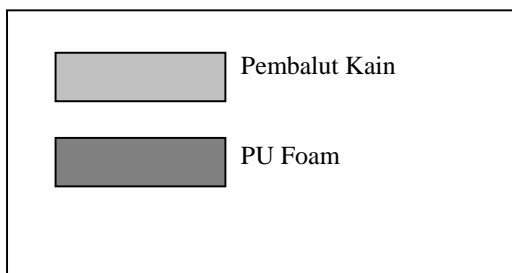
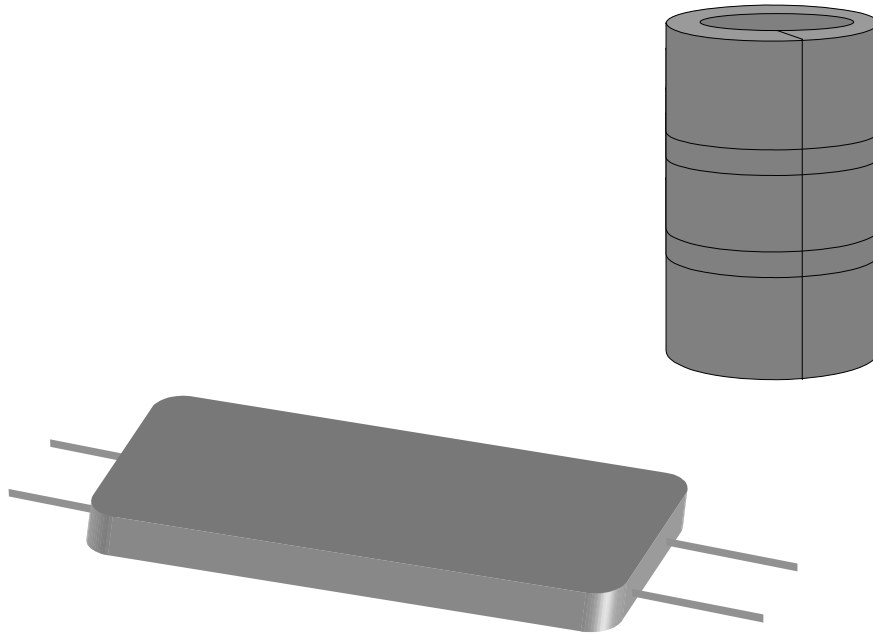

- I. Fabrik bermutu tinggi atau kain calico.
- II. Kain Calico atau P.V.C
- III. Tali ikatan 1'' (Lebar) dan 4'' (Panjang) mengikut jenis kain.
- IV. Ukuran 6'3'' X 3'0'' X 2''

KATIL SOFA

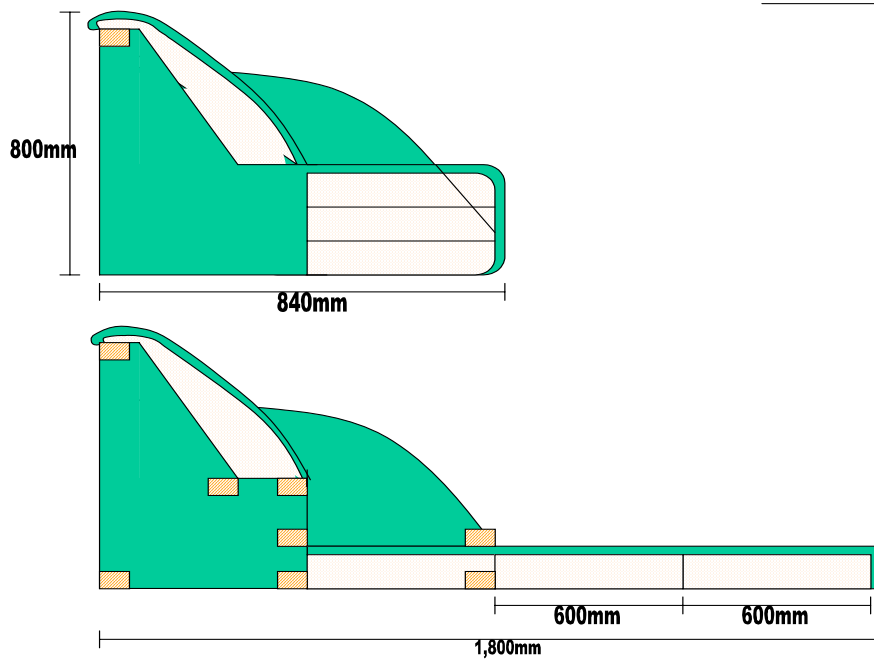

1. Fabrik bermutu tinggi
2. Busa PU berpekatan pertengahan (Medium Density PU Fam).
3. Spring Teras 2.00mm (2.0mm Core Spring)
4. Kayu Teras 1" x 2".
5. Papan Lapis ¾"
6. Ukuran 800mm (T) x 840mm (L) x 1500mm (P).
7. Tilam – 1800mm – yang boleh dilipat tiga (3).

KATIL BERSAMA ALMARI MINI 'A'

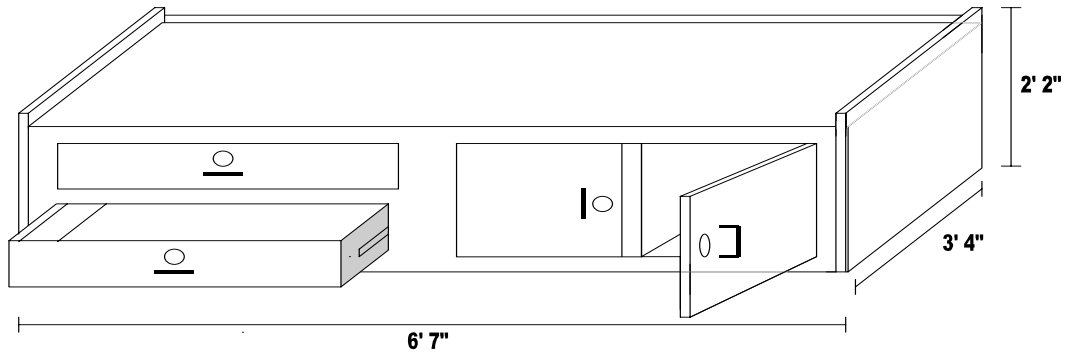

- I. Rangka ½" x 3' kayu keras.
- II. 4mm plywood untuk lapisan rangka.
- III. Setiap katil mempunyai ;
 - a) Dua (2) laci berkunci (36" x 24" x 8") berserta panjang.
 - b) Dua (2) tempat menyimpan barang (16" x 24" x 20") berserta pemegang.
- IV. Laci menggunakan drawer roller.
- V. Almari miini menggunakan dua (2) ansel 3" setiap pintu.
- VI. Lantai katil menggunakan 4mm plywood dan disokong menggunakan 2" x 2" kayu keras di tepi dan tengah katil.
- VII. Setiap permukaan sudut katil dihalusi dan di cat / spray menggunakan tiga lapisan cat timber tone.

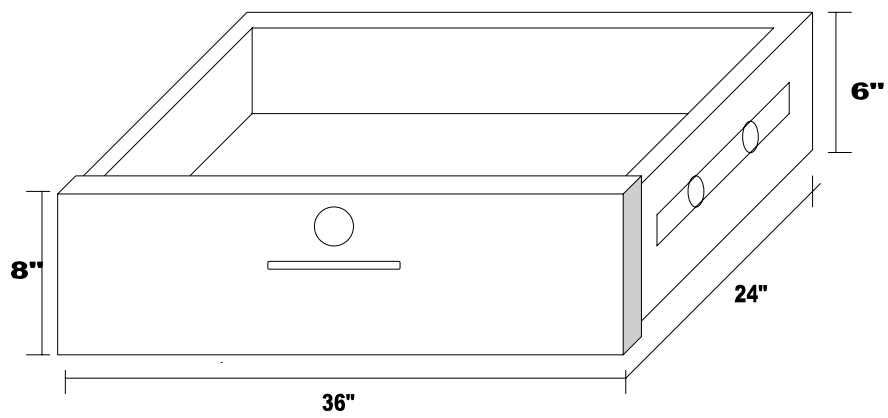

LACI

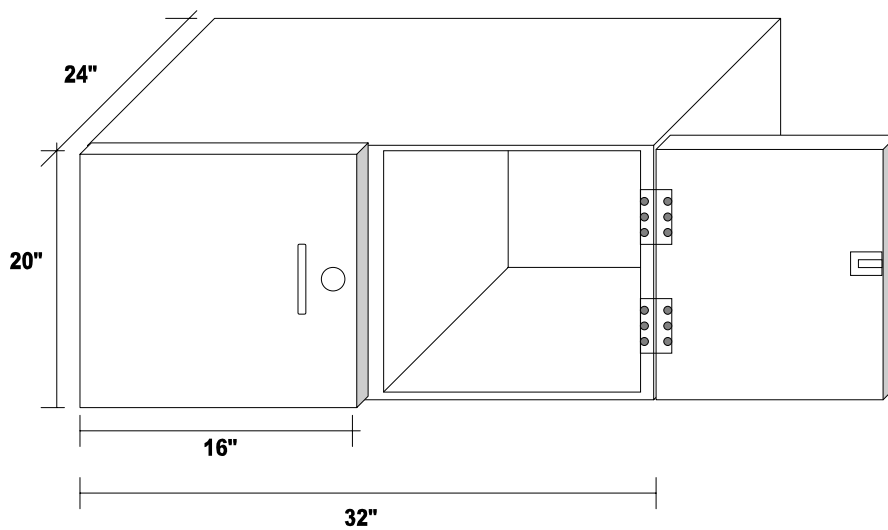

ALMARI

KATIL BERSAMA ALMARI MINI 'B'

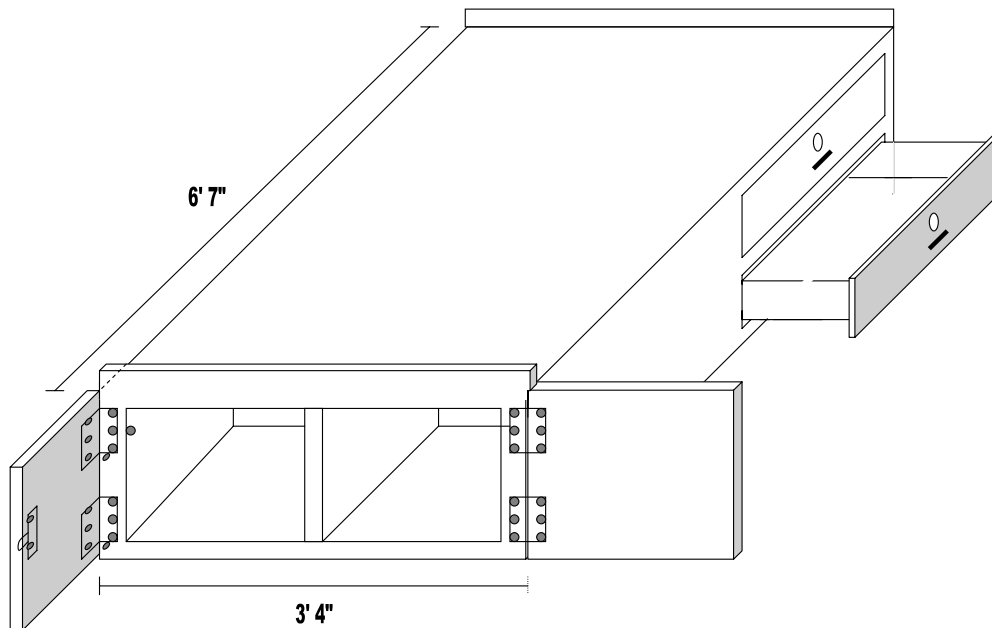

- I. Rangka ½" x 3' kayu keras.
- II. 4mm plywood untuk lapisan rangka.
- III. Setiap katil mempunyai ;
 - a) Dua (2) laci berkunci (36" x 24" x 8") berserta panjang.
 - b) Dua (2) tempat menyimpan barang (16" x 24" x 20") berserta pemegang.
- IV. Laci menggunakan drawer roller.
- V. Almari miini menggunakan dua (2) ansel 3" setiap pintu.
- VI. Lantai katil menggunakan 4mm plywood dan disokong menggunakan 2" x 2" kayu keras di tepi dan tengah katil.
- VII. Setiap permukaan sudut katil dihalusi dan di cat / spray menggunakan tiga lapisan cat timber tone.

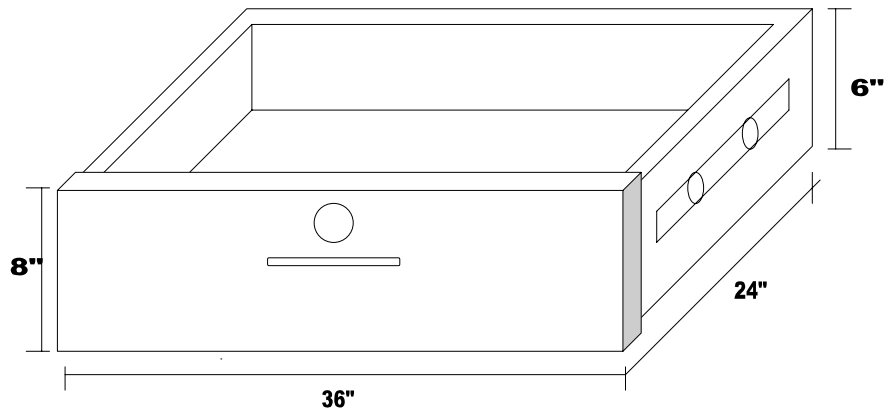

LACI

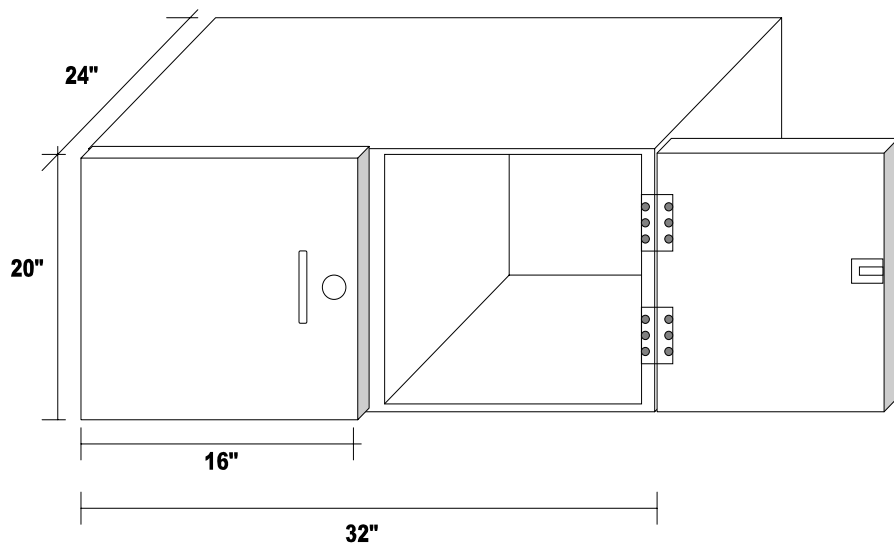

PELAPIK / ALAS TILAM (LINEN PROTECTOR)

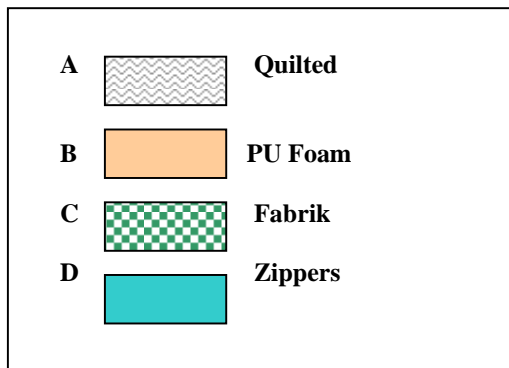
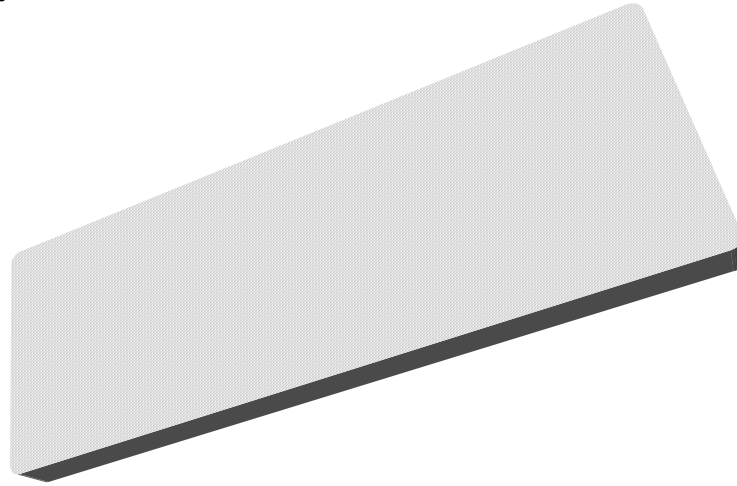
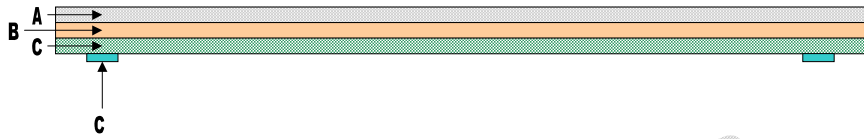

- I. Menggunakan fabrik quilted yang bermutu tinngi.
- II. Menggunakan zippers supaya lapisan tersebut mudah alih.
- III. Ukuran 6' 3" x 3' 0" x 0.25 - Tilam bujang
6' 3" x 5' 0" x 0.25 - TilamKelamin